

Main Color Key

- Northwest Academic Area
- Northeast Academic Area
- Southeast Academic Area
- South Academic Area
- Southwest Academic Area
- Integrated Science Dedicated To The Academic Area Which It Is Colored
- Technology Instruction Dedicated To The Academic Area Which It Is Colored
- Non-Dedicated Technology Instructions
- Media Resource Classrooms
- Business / Management Classrooms
- Intensive Need Classrooms
- Special Science Classrooms

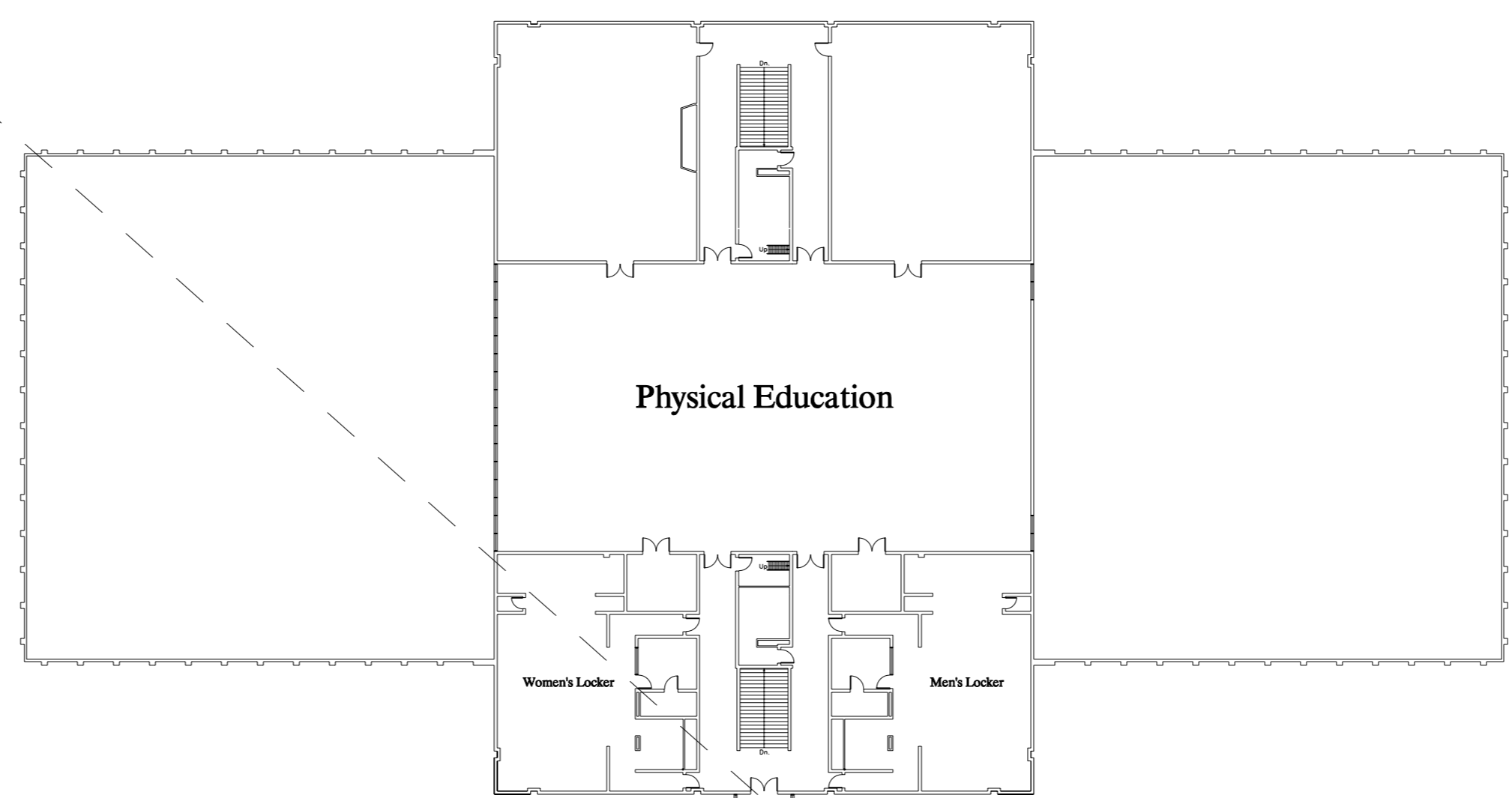

**NORTH-WEST ACADEMIC AREA
400 STUDENTS**

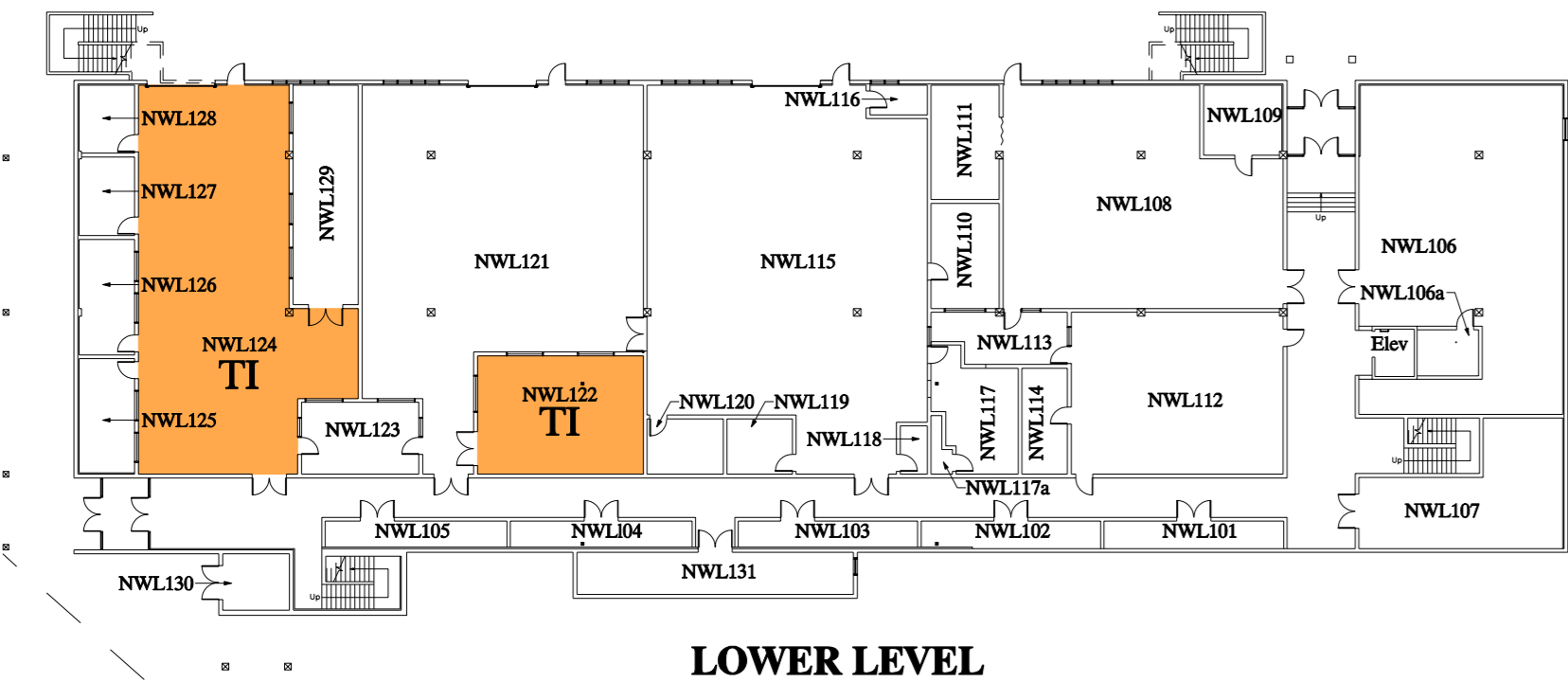
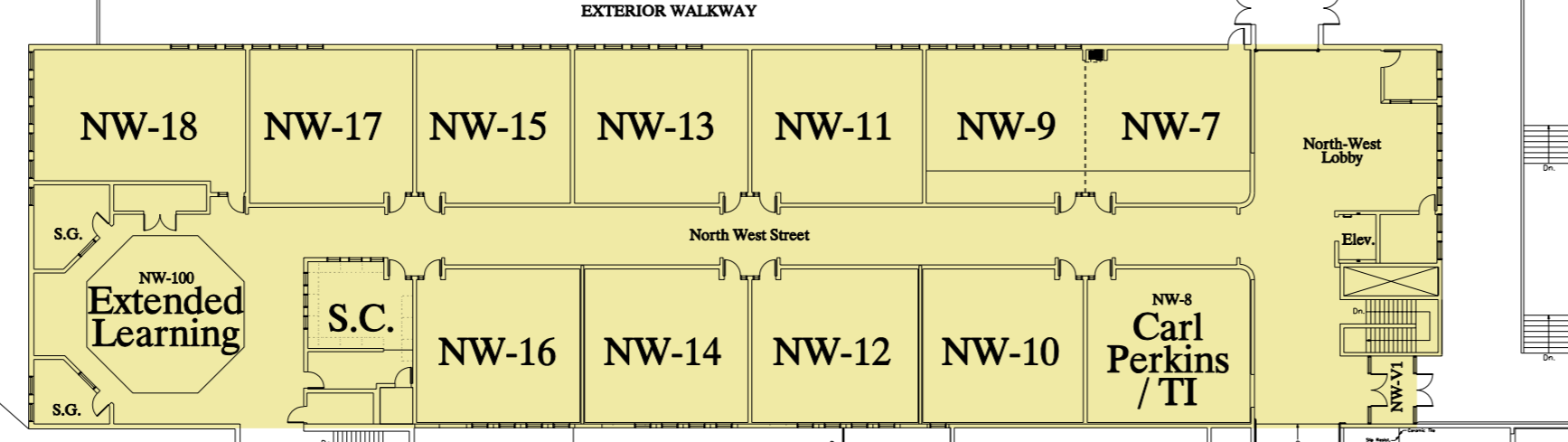

**NORTH-EAST ACADEMIC AREA
400 STUDENTS**

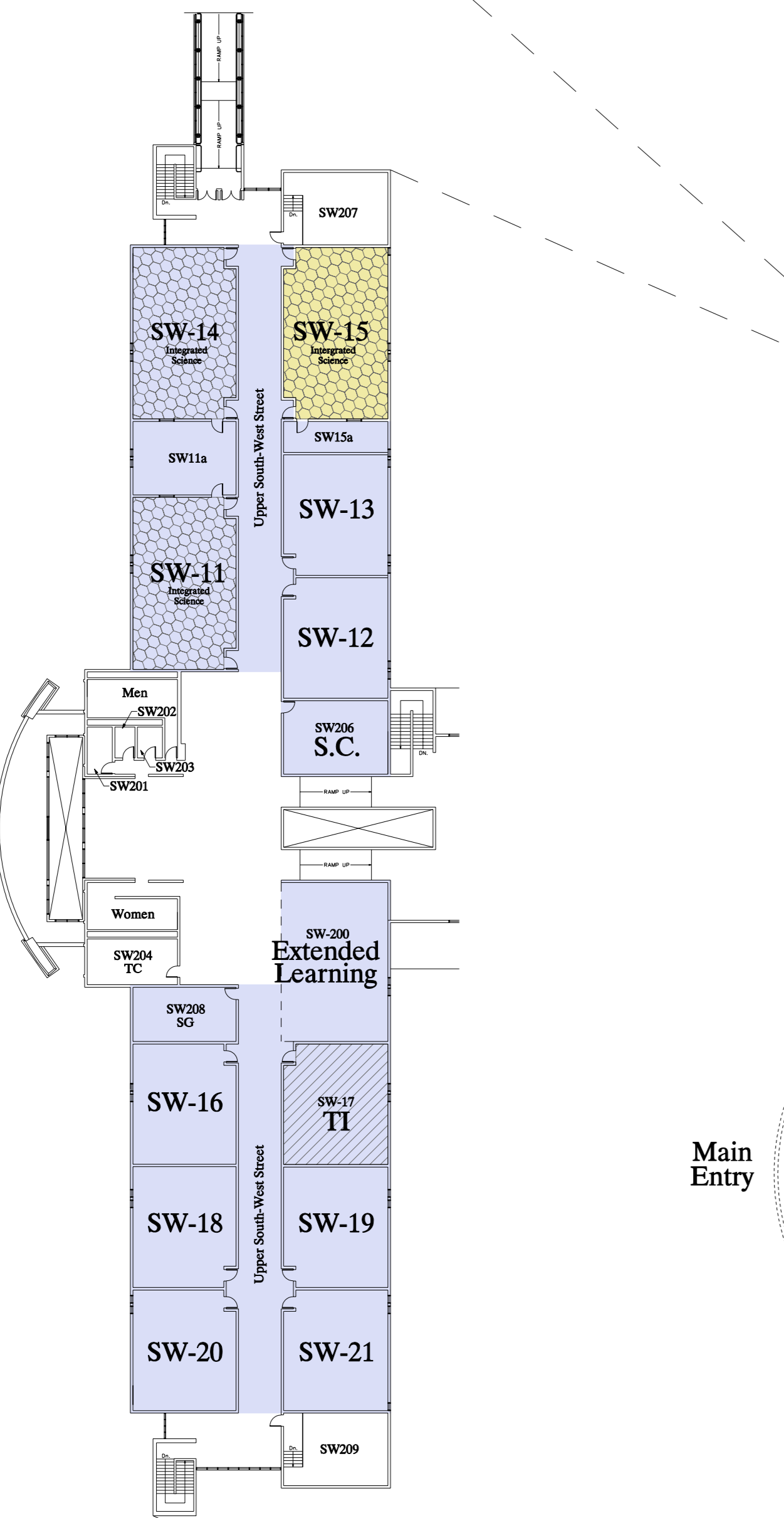
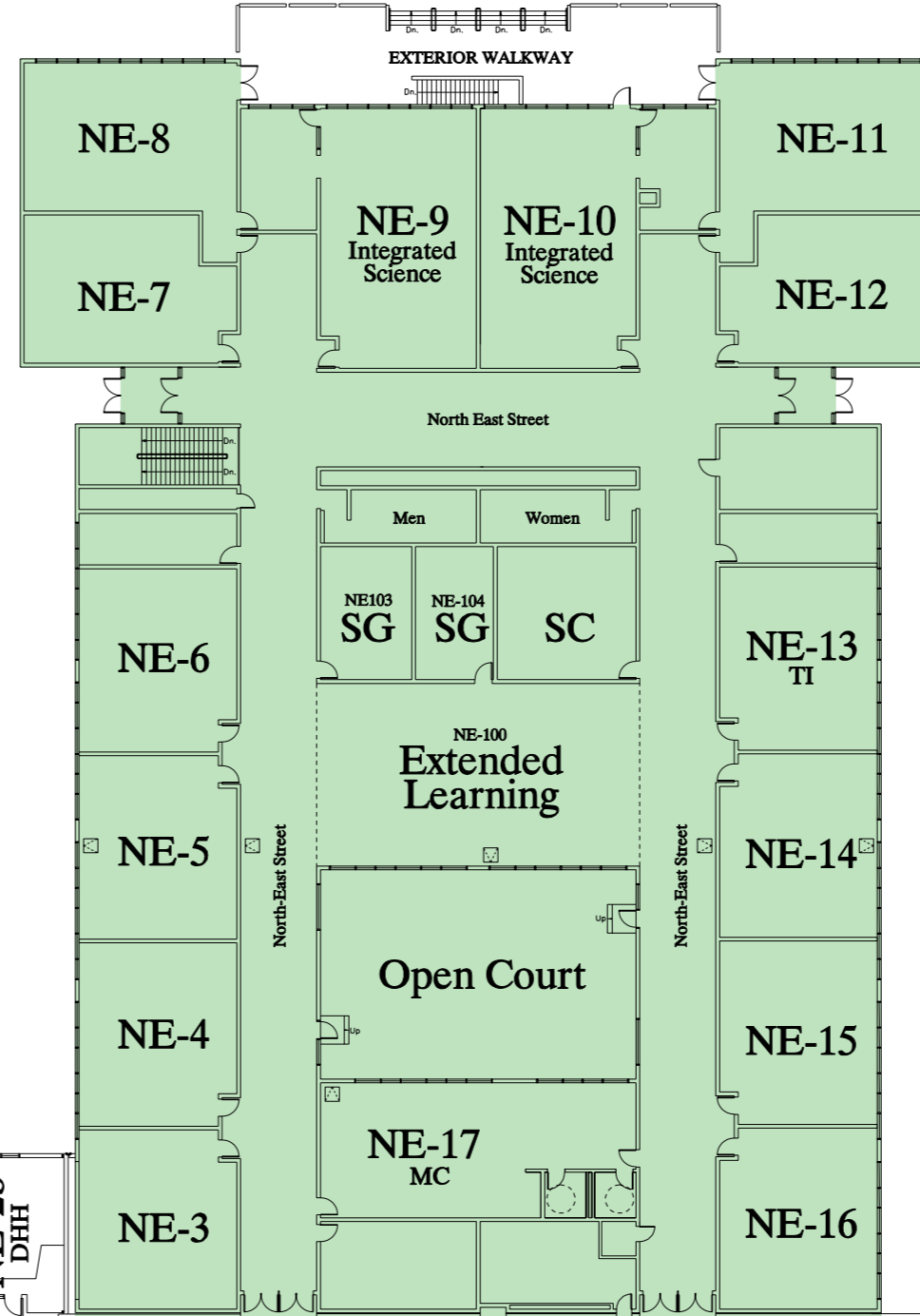

Master Academic Area Plan
Scale: 1/32" = 1'-0"
0 8' 16' 32' 64'

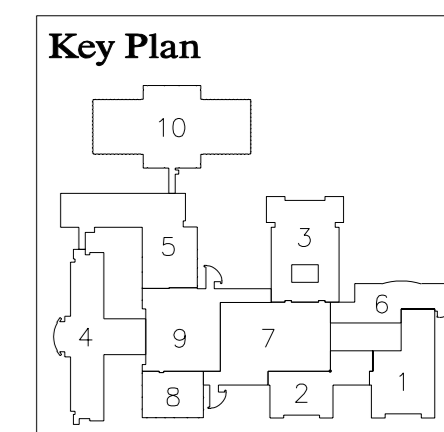

Revisions

Drawn DT Company	Date 12/1/2003
Checked G.L.W.	Job No. 030901

Sheet Contents
MASTER ACADEMIC AREA PLAN

Category A	Sheet MP-A
----------------------	----------------------