

**Main Color Key**

- Administration
- Commons / Extended Learning / Others
- Circulation
- Classroom
- District Space
- Entry / Exit Vestibule
- Kitchen
- Library / Media
- Mechanical/ Storage / Custodian
- Performance Arts
- Physical Education
- Pool
- ROTC Areas
- Stairs
- Visual Arts

**Abbreviations Key**

- BM - Business / Management Classroom
- DHH - Deaf & Hearing Impaired
- IN - Intensive Needs Classroom
- MC - Media Center / Resource Classroom
- SC - Staff Center / Offices and Workroom
- SG - Small Group Room
- TI - Technology Instruction
- TC - Technology Closet
- NW-7 - Northwest Academic Area Classroom 7

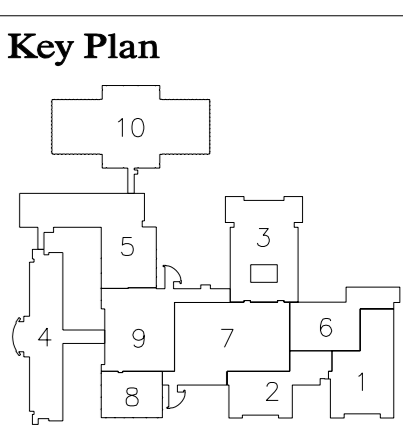

**Revisions**

<b>Drawn</b> DT Company	<b>Date</b> 12/1/2003
<b>Checked</b> G.L.W.	<b>Job No.</b> 030901

**Sheet Contents**  
 PHASES 1, 2 & 3  
 UPPER FLOOR  
 PLAN

<b>Category</b>	<b>Sheet</b>
A	E-U

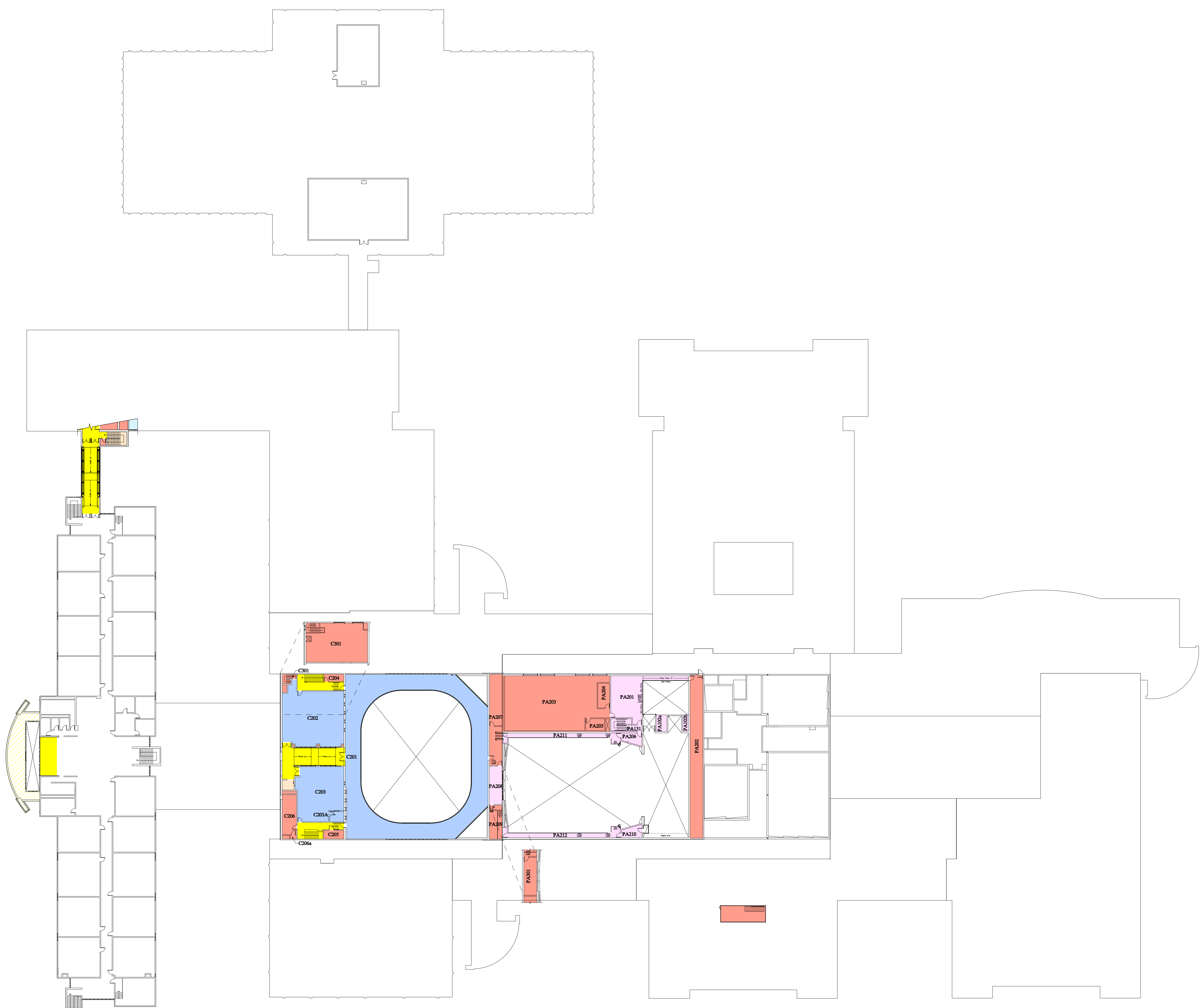

**Phases 1, 2 & 3 Upper Floor Plan**  
 Scale: 1/32" = 1'-0"  
 0 8' 16' 32' 64'